

Olympic Folding Buildings®
Manufactured by Dogwood Industries, LLC

Pricing Effective January 1, 2009

General Pricing Notes

Inclusions

Export crating and shipping dunnage for truck transport, all exterior preformed flashings, exterior lap sheets, mastic for exterior sheeting laps, closed cell preformed flashing closure, wall panel joint insulation (when insulated), bolts, fasteners, lifting eyes, erection manual and erection drawings.

Folding Sections

Folding sections are 10' in width. 8' sections are available to accommodate certain shipping conditions. Buildings are available in any length in section-wide increments.

Design Loads

Olympic Folding Buildings® are designed to meet 2006 International Building Code.

40', 50', 60' and 70' wide models are designed to 40 psf snow load, 30 psf wind load and Seismic Zone III.

All buildings can be customized to specific environments. Snow loads to 250 psf and wind loads to 140 mph available.

Building Type

Type I, Non-Insulated	Folding sections, prefabricated end wall sections, 26 ga. galvanized exterior.
Type II, Insulated R-10	Folding sections, prefabricated end wall sections, 26 ga. galvanized exterior. Factory-installed 2" rigid board insulation with vapor barrier in walls, roof and end walls. Factory-installed 29 ga. galvanized inner liner on walls/roof/end walls.
Type III, Insulated R-20	Folding sections, prefabricated end wall sections, 26 ga. galvanized exterior. Factory-installed 4" rigid board insulation with vapor barrier in walls, roof and end walls. Factory-installed 29 ga. galvanized inner liner on walls/roof/end walls.

Pricing

All pricing in U.S. dollars and subject to change without notice.

Contact Dogwood Industries for pricing for custom sizes and accessories.

All pricing quoted FOB trucks, factory.

Technical Details

Foundation Dimensions

Standard foundation size matches building size. (4018x100 fits on a 40' x 100' foundation.) Buildings can be customized in both dimensions to fit existing foundations.

Anchor Bolts

Use drilled-in-place expansion anchor bolts or epoxy anchor bolts in concrete foundations or lag bolts in timber foundation applications.

Pre-set anchor bolts are not required and must not be used due to interference with proper installation of folding sections.

Each main section requires 8 total bolts; each end wall section requires 2-4 bolts depending on building size.

Engineering

Design engineering is included in price from bottom of column base plates upward. End user is responsible for design of foundation from top of foundation downward. Additional engineering fees may apply for compliance with local building officials or custom building design.

Finish

Primary and secondary steel are finished with one coat of corrosion-resistant primer; upgraded finishes are available.

Interior liner, exterior cladding and flashing are galvanized finish. Painted finishes and alternate metal cladding are available.

Olympic Folding Buildings®
 Manufactured by Dogwood Industries, LLC

Pricing Effective January 1, 2009

Folding Buildings®

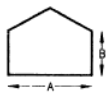

10' Folding Sections	
100' Building	
10 Sections /	Add or Subtract:
2 End walls	Per Section

10' Folding Sections	
100' Building	
10 Sections /	Add or Subtract:
2 End walls	Per Section

A40-B18				A60-B18					
4018 Type I	\$	126,437	\$	9,893	6018 Type I	\$	176,573	\$	13,423
4018 Type II	\$	151,513	\$	11,928	6018 Type II	\$	208,716	\$	15,937
4018 Type III	\$	165,064	\$	13,028	6018 Type III	\$	222,266	\$	16,997

A50-B25				A70-B30					
5025 Type I	\$	163,436	\$	12,391	7030 Type I	\$	336,659	\$	23,938
5025 Type II	\$	194,572	\$	14,818	7030 Type II	\$	386,935	\$	27,605
5025 Type III	\$	208,527	\$	15,906	7030 Type III	\$	406,934	\$	29,065

Note: Above pricing represents most common building sizes; structure can adapt to many configurations. Call to discuss your specific needs.

Steel Lean-To Additions

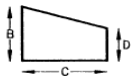

10' Folding Sections	
100' Building	
10 Sections /	Add or Subtract:
Call for pricing.	Call for pricing.

Lean-to additions available to match any building size, custom designed for building application.
 Lean-to additions are panelized to match main building sections for ease of transport and erection.

Olympic Folding Buildings®
 Manufactured by Dogwood Industries, LLC

Pricing Effective January 1, 2009

Olympic Folding Buildings® Options & Accessories

All Olympic Folding Buildings® can be customized to meet your requirements. Use the information below to determine which options and accessories will complete your building, then call Dogwood for a complete package price to meet your exact requirements.

<u>Item</u>	<u>Size</u>	<u>QTY Required</u>	<u>Price Each</u>	<u>Specify Location</u>
Steel Personnel Doors <i>location</i>				
Standard hollow metal door and factory installed frame. Locking hardware (US26D), storm chains and thresholds included. Prime painted or finish painted to match building color. Hardware upgrades, insulated doors, and custom sizes available.	3070			
	6070			
Windows <i>specify size W x H</i> <i>location</i>				
Aluminum sliding window, insulated glass (Field Installed)				
Translucent Panels <i>panel width x L</i> <i>roof or wall</i>				
Clear fiberglass (Factory Installed)				
Steel Spreader Bars and Rigging Packages				
1 piece for buildings up to 60'	40'-60' spans			
3 piece required for 70' spans	70' span			
Includes all required wire rope and clevis				
Rotary Roof Vents & Transition Boots <i>specify venting requirement</i>				
Manually operated with chain				
Screened Louvers <i>specify size</i> <i>location / finish</i>				
Mill finish aluminum or painted steel Fixed or Operable Power actuated				
Steel Framed Openings <i>specify size W x H</i> <i>location</i>				
Framed openings to accommodate equipment access or specialty door/curtain installation. Openings fully trimmed to match building interior and exterior cladding. Note: Sidewall openings require 2' minimum clearance between head and eave.				
Steel Sectional or Coiling Overhead Doors <i>specify size W x H</i> <i>location / type</i>				
As manufactured by Overhead Door Co. Insulated or un-insulated. Electric Operator or Chain Hoist. Std. sizes up to 30Wx28H. Inquire for larger sizes / custom configurations. Door design integrated with structure for ease of installation and operation.				
			<i>electric operator Y/N</i>	
Steel Sliding Doors <i>specify size W x H</i> <i>location</i>				
Sliding doors have two leaves; a 14'x14' sliding door has two 7'x14' leaves, each manually operated. Doors are complete with track, trolley and all necessary standard hardware. Door finish and insulation match building type. (A sliding door on a Type II building will have 26 ga. exterior cladding, R-10 Insulation, and a 29 ga. liner.)				
Reinforced Building for 1-Ton Monorail <i>specify length</i> <i>location</i>				

Olympic Folding Buildings®
Manufactured by Dogwood Industries, LLC

Pricing Effective January 1, 2009

Additional Services

Foundation Design

Foundation design may be included at the client's option in Dogwood's overall design package for an additional fee. Dogwood can also provide foundation installation. See note below.

Heating Package

Dogwood Industries can design and supply a complete turn-key heating system for your Olympic Folding Building®. Designs are flexible to accommodate energy sources, fuel types, and use patterns. Systems ship with all parts and installation components included and manifested for a cost effective installation. Design to IMC 2006 and applicable local codes. Schematics included.

Electrical Service & Lighting

Dogwood Industries can design and supply a complete turn-key electrical service and lighting system for your Olympic Folding Building®. Standard designs include interior area lighting and exterior lighting at doors, convenience outlets, panel board, disconnect and meter base (where applicable). Upgrades include high amperage/high voltage service, exterior area lighting, interior task specific lighting, and transformers. Systems ship complete with all wiring, conduit, boxes, connection and mounting hardware, manifested and packaged for cost effective installation. Design to NEC 2005 and applicable local codes. Schematics included.

Erection and Installation Services

Dogwood Industries is a full service general contractor with many years of remote site work. We provide on-site services ranging from erection coordination and oversight to total project execution. Dogwood field teams are experienced with the folding building system and provide a rapid and safe installation of your building.

Custom Dimension Request

Using drawing, specify end user's clearance requirements.

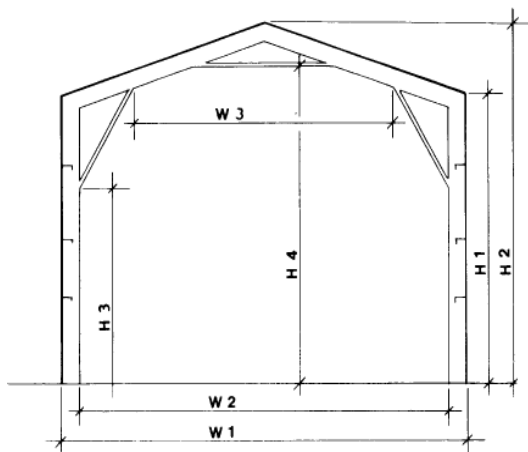

W-1	
W-2	
W-3	
H-1	
H-2	
H-3	
H-4	

On critical clearance requirements, end user should verify dimensions with manufacturer.

Width is measured from outside to outside of sidewall. Eave height is measured from base of sidewall column leg to point where exterior sidewall metal and exterior roof metal meet. Roof slope is nominal 4" of rise for every 12" of run, or approximately 18 1/2 degrees.